

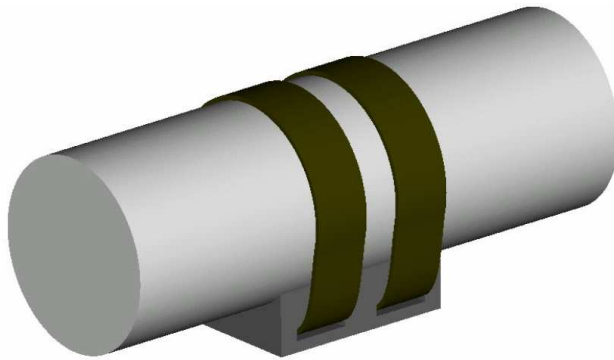

ANTI-CORROSION SADDLE EME-ACS-800-2SL (UP TO +80 °C)



Prevents corrosion problems.

The points where pipe crosses support steel without the utilisation of a shoe support has repeatedly proven to be a major corrosion problem. The coating breaks down as a result of abrasion. This will cause corrosion and deterioration of the pipe.

Cost benefit.

Justification of the initial expense of these saddles lies with the life cycle costs; having to repair or replace piping after a few years is very expensive

Ease of installation. Easy to install due flexible non-metallic UV-resistant polyamid straps.

Advantages:

- * No metal to metal contact
- * No corrosion
- * Moulded to the outside diameter of the pipe

Material: Eslin type D70 -30 up to +80 °C

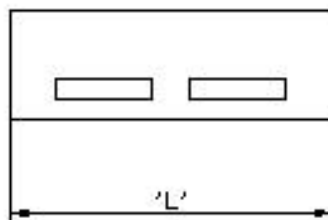
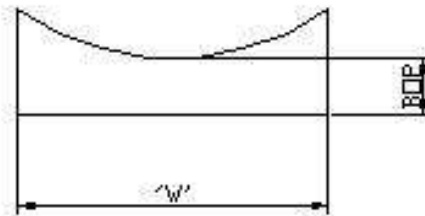

Strap type

Strap type	Strap length (mm)	Strap width (mm)	Break strength
A	290	7.6	50 kg
B	430	9.0	75 kg
C	480	13.0	105 kg
D	530	9.0	75 kg
E	580	13.0	105 kg
F	710	9.0	75 kg
G	730	13.0	105 kg

Saddle dimensions

NPS	Pipe DN	'W'	'L'	BOP	Max. Load (kN)	Strap type
1"	25	25	50	9	5	A, B or C
1-1/4"	32	25	50	9	5	A, B or C
1-1/2"	40	35	50	9	7	A, B or C
2"	50	40	50	9	8	B or C
3"	80	50	50	9	10	C or D
4"	100	50	75	9	15	D or E
6"	150	75	75	9	22	F or G

Other sizes or thicknesses upon request

Ordering part number :

EME-ACS-800-2SL- ... - ...

NPS = 1" to 6" _____

_____strap type

example: EME-ACS-800-2SL-2"-C



NON-METALLIC WEAR PAD (+150 °C) EME-WP

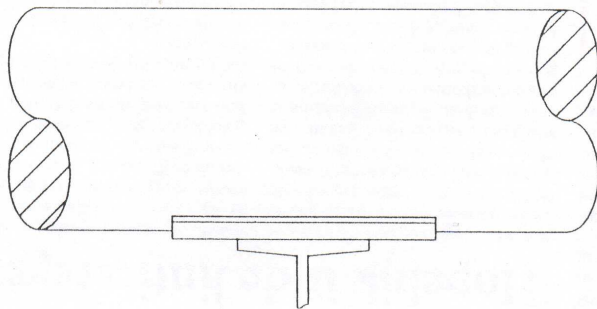
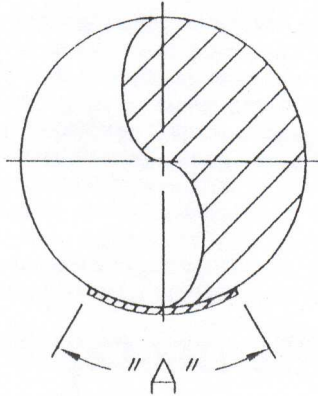

Prevents corrosion problems. At the points where pipe crosses support steel without the utilization of a shoe support, the coating will break down as a result of abrasion. This will cause corrosion and deterioration of the pipe and support, eventually resulting in failure of the pipe wall.

Justification of the initial expense of these wear pads lies with the life cycle costs; having to repair or replace this piping after a few years is very expensive.

Ease of installation. Wear pad is moulded to the exact outside diameter of the pipe and then cut to cover the exact length and degree you wish. Glue can be included in the supply.

Advantages: No metal to metal contact, no corrosion, no moisture penetration, no electrical current and cost compared to a welded system is considerably less on installed basis.

Material. Fibreglass wear pad with resilient two-part epoxy adhesive.

Mounting instruction. Correct procedure is available to assure a sound installation.

Part Number	NPS	'A'	Thick	Standard length
EME-WP-021	1/2"	90°	6	300
EME-WP-027	3/4"	90°	6	300
EME-WP-034	1"	90°	6	300
EME-WP-043	1-1/4"	90°	6	300
EME-WP-049	1-1/2"	90°	6	300
EME-WP-061	2"	90°	6	300
EME-WP-089	3"	90°	6	300
EME-WP-115	4"	90°	6	300
EME-WP-168	6"	60°	6	300
EME-WP-219	8"	60°	6	300
EME-WP-273	10"	60°	6	300
EME-WP-324	12"	30°	6	300
EME-WP-356	14"	30°	6	300
EME-WP-406	16"	30°	6	300
EME-WP-457	18"	30°	6	300
EME-WP-508	20"	30°	6	300
EME-WP-610	24"	30°	6	300

Up to 48" is possible

Issue 2008